



Product document pack

Use this document with the supporting evidence pack for the KCFD1 fire-rated doorset. The current online document pack includes the fitting instructions, Declaration of Performance, Certificate of Constancy of Performance and classification evidence.



Docs / evidence pack:

kirnsecuredoors.com/kcfd

Scan or type the short address to access the current document set.

Product and evidence references

Product / Model	KCFD1
DoP No	KCFD
CoCoP No	2812-CPR-MA7793
Classification standard	EN 13501-2:2023
Performance	EI ₂ 15 / EI ₂ 20 / E90 / EW90
Smoke control	NPD
Self-closing	C

Documents to retain at handover

- This fitting instruction document
- Declaration of Performance
- Certificate of Constancy of Performance
- EN 13501-2:2023 classification evidence
- Completed Fire Door ID Plate with Traceability Ref

Important: The declared fire performance is valid only where the door, frame, seals, hardware, closer and installation details comply with the supplied instructions and supporting evidence. Retain the completed Fire Door ID Plate details with the handover documents.



Fire Rated 10-Point Locking Door Installation Instructions



CAUTION - READ FIRST: Failure to follow these installation instructions may result in injury, incorrect fire-door performance, or invalidation of the warranty. Care should be taken when handling the door. The installer is responsible for ensuring that the correct number of competent people are available during lifting, fitting and handling, and that all hardware is fitted correctly.



IMPORTANT: CE MARKING HARDWARE AND FIRE PERFORMANCE

Please note that the handles, cylinders, locks and hinges supplied with this door are only fire rated and certified when used in conjunction with this door and frame. They are not to be sold or supplied separately as fire rated products. They have no fire performance characteristics, testing or certification when they are not fitted to this door.



1. Handle and cylinder fitting

Scan the QR code for the current Kirncroft handle and lock-cylinder fitting instructions before installing the hardware. Fit only the supplied or approved components for this doorset. Do not substitute locks, cylinders, hinges, closers, seals or other hardware unless covered by the applicable test evidence, classification, EXAP, certificate scope or written approval.

Landing page: kirmsecuredoors.com/kcfd

2. Position the door in the opening

Ensure that the aperture is square, plumb and the correct size for the door. The opening size should be 10 mm larger than the frame unless project-specific instructions state otherwise.

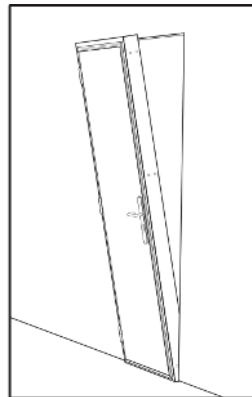

3. Stand the door upright

Position the bottom of the door in the aperture, then push it up so that it stands vertically. Do not use the handle to lift or manoeuvre the door.

4. Square and fix the frame

Make sure the flange at the top of the door runs square to the top of the door frame. If it is not square, pull the frame until it is square. The frame can then be welded in place or bolted through the fixing holes as required by the approved installation detail.

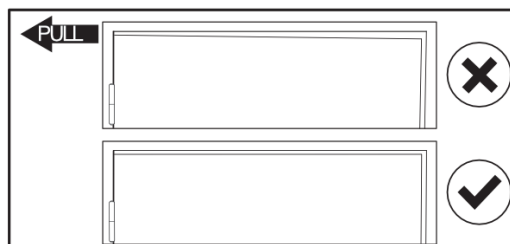



Fire Rated 10-Point Locking Door Installation Instructions

5. Fit caps and weather seal

Insert the fixing-hole caps and affix the self-adhesive weather seal to the door frame as shown. The door is not declared as a smoke-control doorset; smoke performance is not declared.

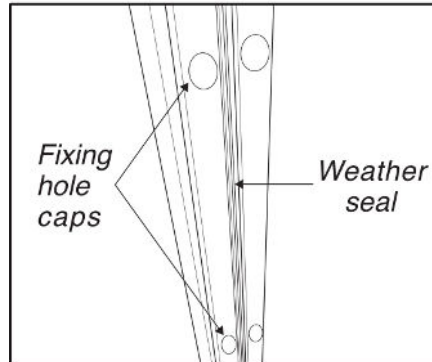

Hydraulic closer

Use the fixing screws already fixed into the door and frame to affix the CE marked hydraulic closer to the door. Once installed, check that the door self-closes with enough force to latch fully. Refer to the closer manufacturer's instructions for power controls and assembly details.

Surface mounting

Do not drill or screw through the door or frame. Unauthorised drilling, added ironmongery, altered seals or site modification may invalidate the declared fire performance.

CE / product identification summary

 2812 YY: 22	Kircroft Engineering Ltd Wadworth Hill, Burstwick, Hull, UK, HU12 9EY Manufacturing plant: E014070-1 CoCoP: 2812-CPR-MA7793 DoP: KCFD	Product/model: KCFD1 Standards: EN 16034:2014; EN 14351-1:2006+A2:2016; classification to EN 13501-2:2023 Fire performance: E90 / EW90 / EI ₂ 15 / EI ₂ 20 Smoke control: NPD Self-closing: C Durability of self-closing: NPD
---	---	---

Important: The declared fire performance is valid only where the door, frame, seals, hardware, closer and installation details comply with the supplied instructions and supporting evidence. Retain this document with the Declaration of Performance, Certificate of Constasy of Performance, EN 13501-2 classification evidence, and completed Fire Door ID Plate / traceability reference at handover.